

ITEM NO.: 1153



Soccer Goal Assemble Instruction Manual

CAUTION:

1. CHECK ALL CONTENTS ARE INCLUDED BEFORE ASSEMBLY.
2. ALWAYS ASSEMBLE AND DISASSEMBLE THE PRODUCT UNDER ADULT SUPERVISION.
3. ANY BREAKAGE FOUND ON THE PRODUCT, PLEASE STOP ASSEMBLING OR DISASSEMBLING IT.
4. CHECK THE EQUIPMENT BEFORE EACH TIME USE IT.

CONTENTS:

1. "L" STYLE FRAME TUBE (2PCS)
2. "L" STYLE FRAME TUBE (2PCS)
3. FRAME TUBE (2PCS)
4. FRAME TUBE (2PCS)
5. FRAME TUBE (2PCS)
6. "L" STYLE FRAME TUBE (1PC)
7. "L" STYLE FRAME TUBE (1PC)
8. SUPPORT TUBE (2PCS)
9. "L" STYLE SUPPORT TUBE (2PCS)
10. TARGET HOOK (12PCS)
11. BOLT (4PCS)
12. WASHER (4PCS)
13. WINGNUT (4PCS)
14. ELASTIC LOOPS (6PCS)
15. NET TIES (35PCS)
16. TARGET PANEL (1PC)
17. NET (1PC)
18. "U" STYLE GROUND PEG (TARGET PANEL USAGE) (6PCS)
19. "J" STYLE GROUND PEG (FRAME USAGE) (10PCS)

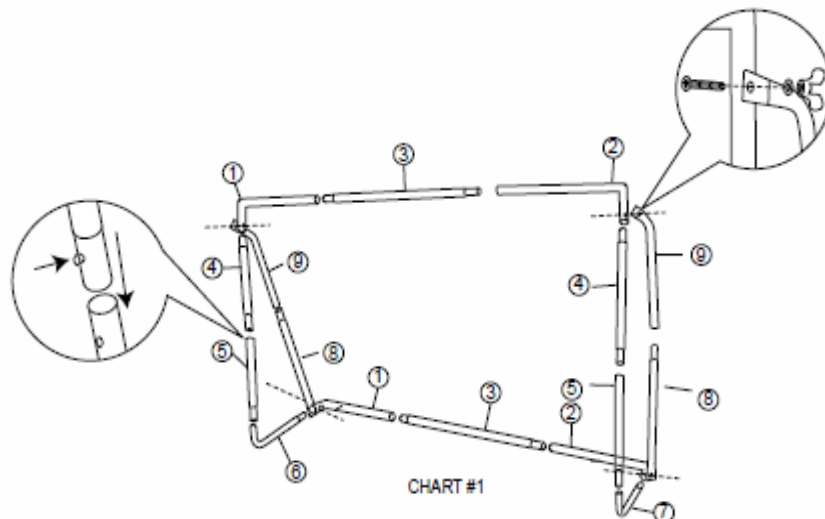
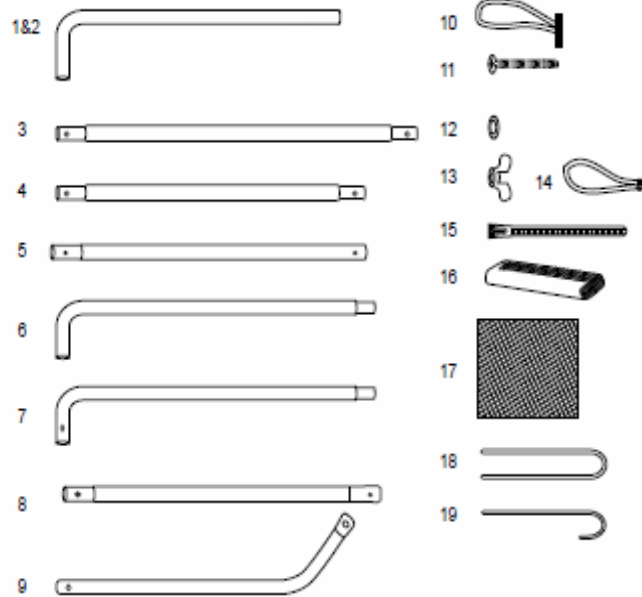

1. JOINT EACH FRAME & SUPPORT TUBE AS CHART # 1 SHOWN.



Soccer Goal

Assemble Instruction Manual

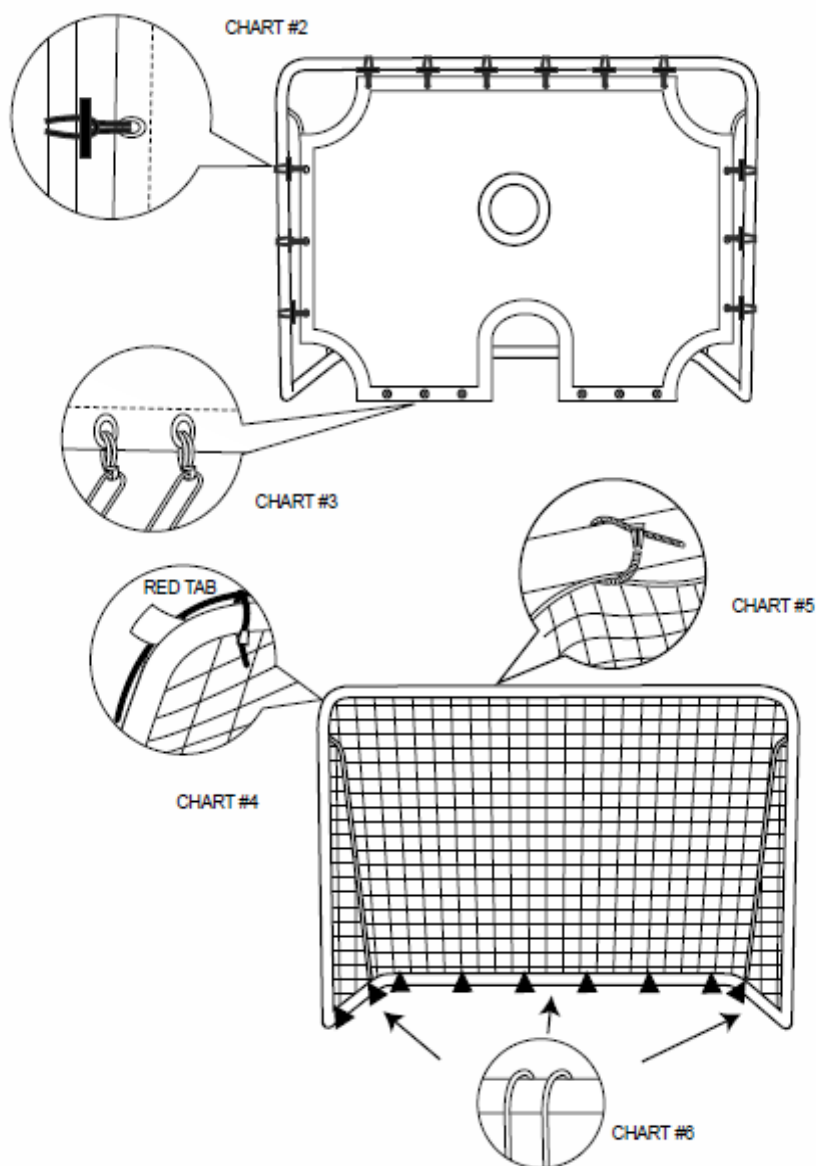

2. SPACE OUT ELASTIC HOOK THE MATCH THE EYELETS IN THE TARGET PANEL. HOOK THE TARGET INTO POSITION AS CHART #2 SHOWN.
3. ON THE BOTTOM OF TARGET PANEL, PLEASE THREAD THE ELASTIC LOOP (14) THROUGH THE EYELETS AND FASTEN TO THE GROUND WITH "J" STYLE HOOD AS CHART #3.
4. SPREAD THE NET OUT AND LOCATE THE RED TABS ON LEFT-TOP AND RIGHT-TOP CORNERS. TIGHT THE NET WITH FRAME BY USING NET TIES AS CHART #4 & #5. THE SEAM OF NET HAS TO FOLLOW THE SUPPORT TUBE.
5. USING "U" STYLE HOOD TO SECURE THE GOAL AS CHART #6 SHOWN.

-
1. DO NOT CLIMB THE PRODUCT.
 2. DO NOT HANG ON THE PRODUCT.
 3. DO NOT PLACE THE PRODUCT NEAR THE FLAME AREA.

WWW.EJETSPORT.COM