

# Basketball System

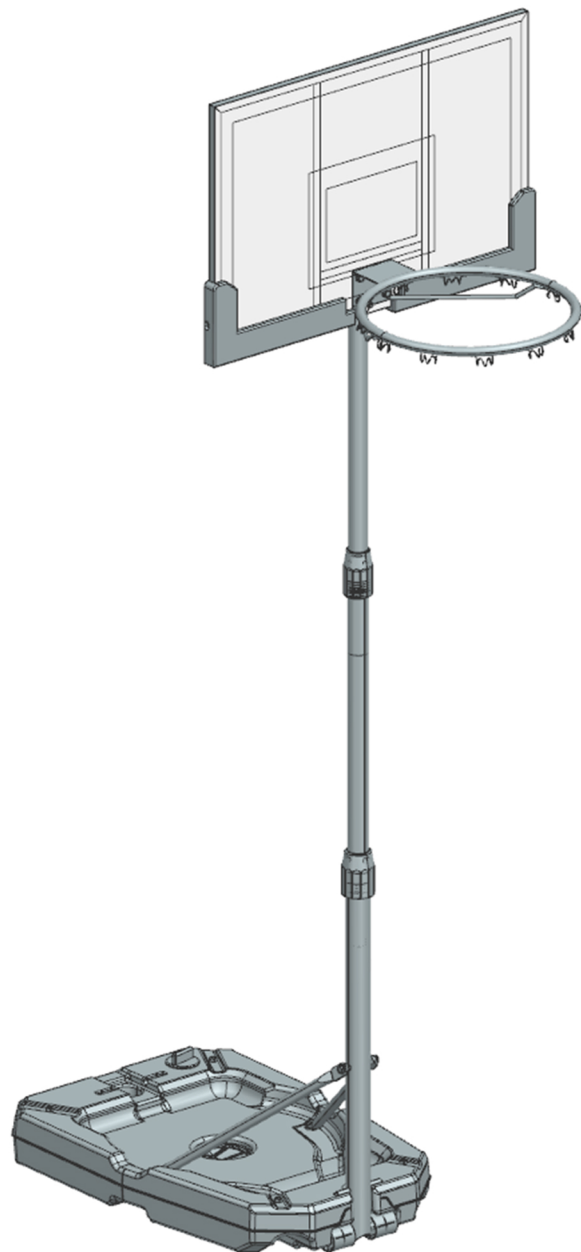

**WARNING:**  
IMPROPER INSTALLATION OR  
SWINGING ON THE RING MAY  
CAUSE SERIOUS INJURY  
OR DEATH

## User Manual

- \*All the basketball systems, including those used for displays must be assembled and ballasted according to instructions. Failure to follow instructions could result in serious injury.
- \*Please read all warnings and cautions before assembly. It is recommended to supervise children as they play with this product. This product is to be assembly by 2 adults only!



# SAFETY INSTRUCTIONS



**FAILURE TO FOLLOW THESE SAFETY INSTRUCTIONS MAY RESULT IN SERIOUS INJURY OR PROPERTY DAMAGE AND WILL VOID WARRANTY.**

Owner must ensure that all players know and follow these rules for safe operation of the system.

To ensure safety, do not attempt to assemble this system without following the instructions carefully.

Check entire box and inside all packing material for parts and/or additional instruction material.

Before beginning assembly, read the instructions and identify parts according to this manual.

Proper and complete assembly, use, and supervision are essential for proper operation and to reduce the risk of accident or injury.

A high probability of serious injury exists if this system is not installed, maintained, and operated properly.

If using a ladder during assembly, please be more carefully.

Two(2) capable adults are recommended for this operation.

Check base regularly for leakage. Slow leaks could cause system to tip over unexpectedly.

Seat the pole sections properly (if applicable). Failure to do so could allow the pole sections to separate during play and/or transport of the system.

Climate, corrosion, or misuse could result in system failure.

This equipment is intended for home recreational use only and not excessive competitive play.

The life of your basketball pole depends on many conditions. The climate, placement of the pole, location of the pole, exposure to corrosives such as pesticides, herbicides, or salts are all important.

If technical assistance is required, contact Customer Service.

Adult supervision is recommended when adjusting height.

Most injuries are caused by misuse and/or not following instructions. Use caution when using this system.

## Get to Know the Basic Parts



# Part List

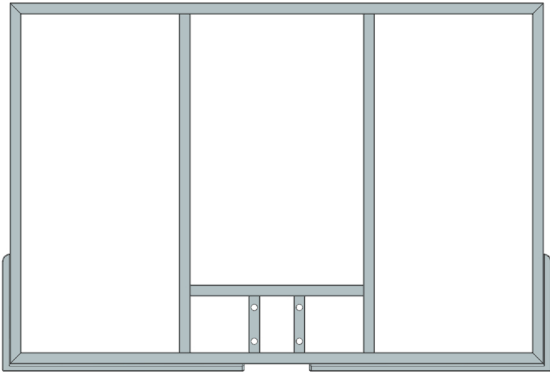

1

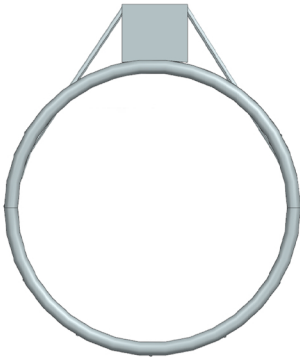

2



3

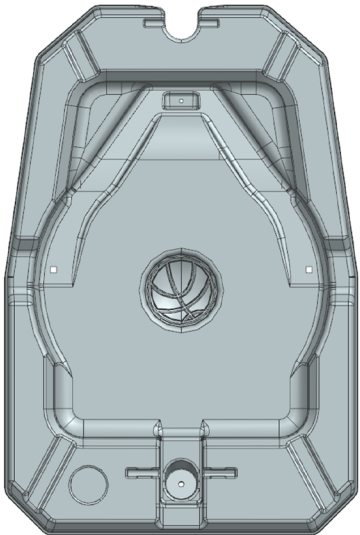

4

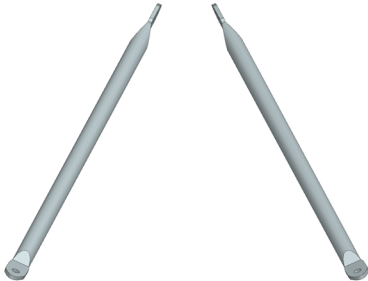

5



6



11



7



8



9

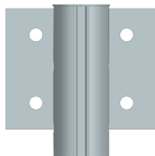

10



## Bolt and Washer Kit



M8X40mm



M8X35mm

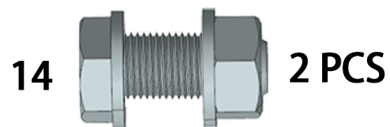

M8X20mm

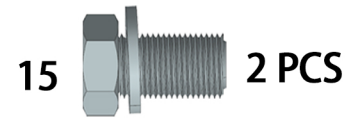

M8X10mm

## Net Installation Outside View

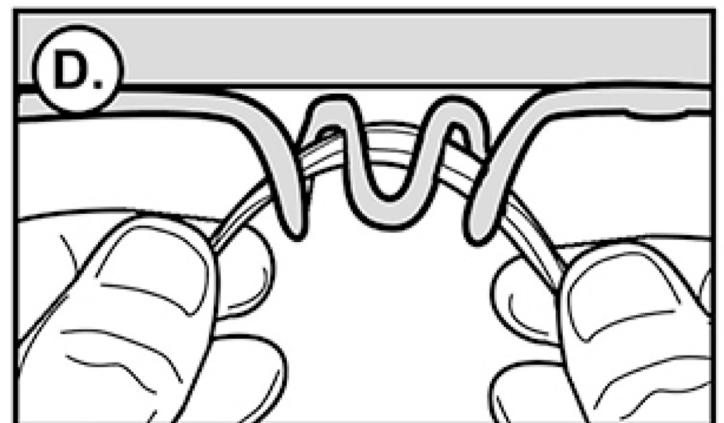
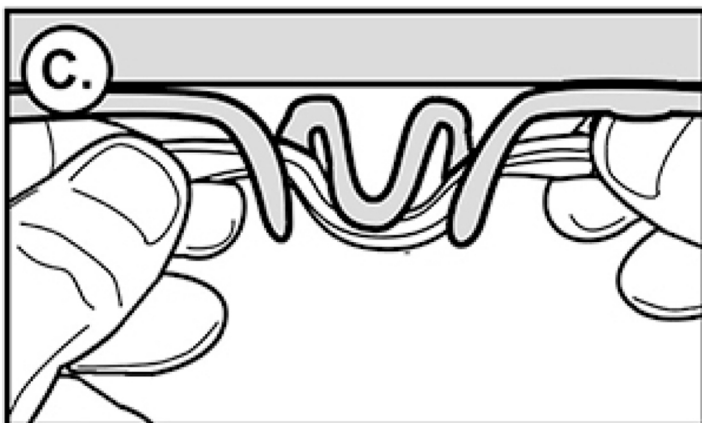
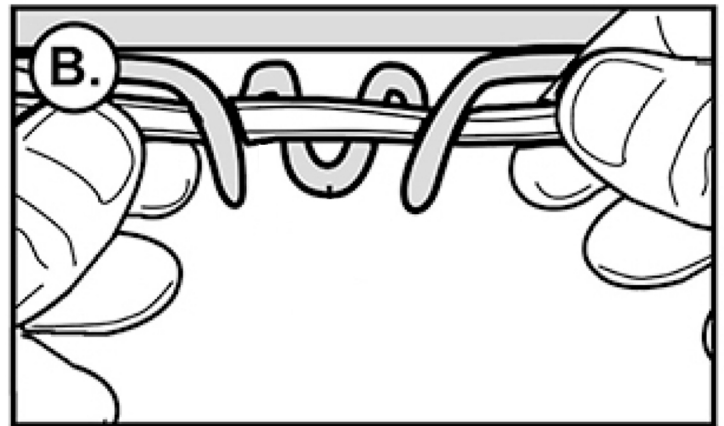
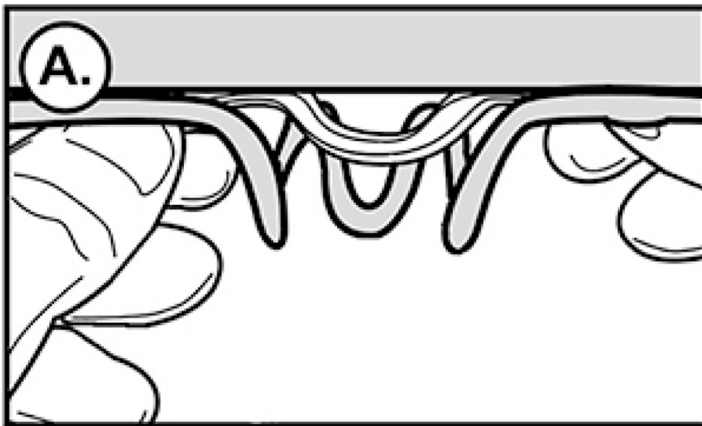

**Step 1** As shown in the figure, insert the short pin (8) into the hole on the lower rod (6), and then connect the lower rod (6) and the wheel (7) together with the long pin (8)

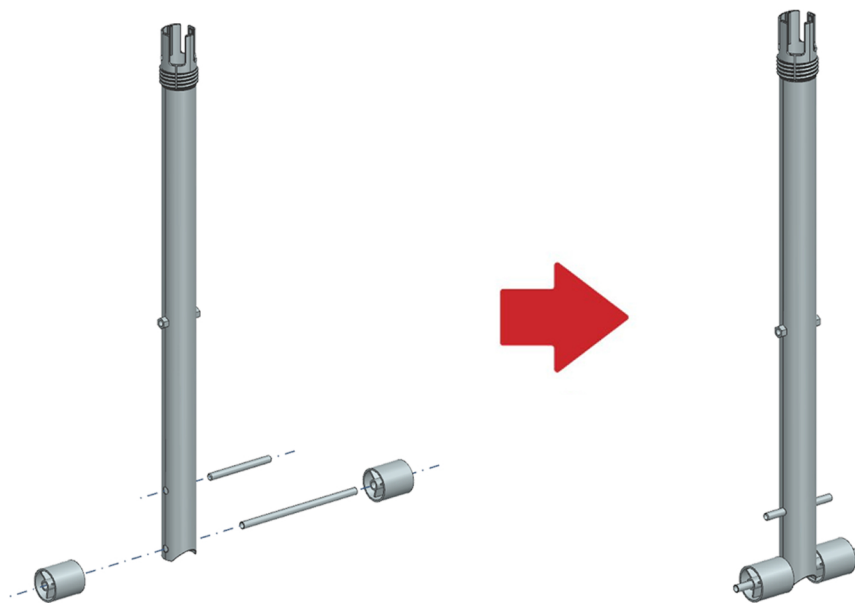

**Step 2** As shown in the figure, insert the long pin (8) on the lower rod into the base (4), then rotate the lower rod 90 degrees to stand up, and finally insert the short pin (8) into the upper gap of the base (4)

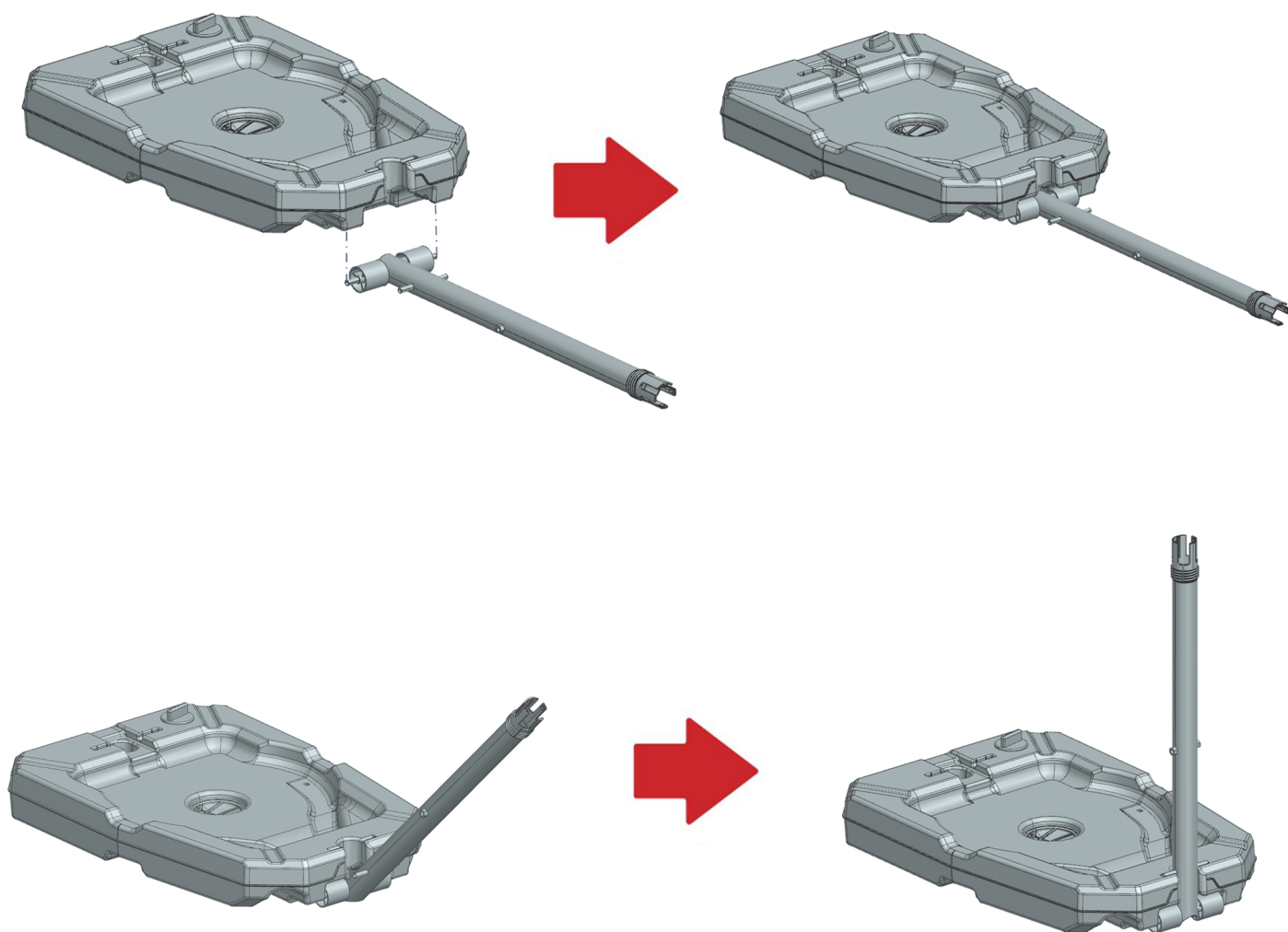

**Step 3** As shown in the figure, connect the lower rod (6) and diagonal rod (5) with screws (15)

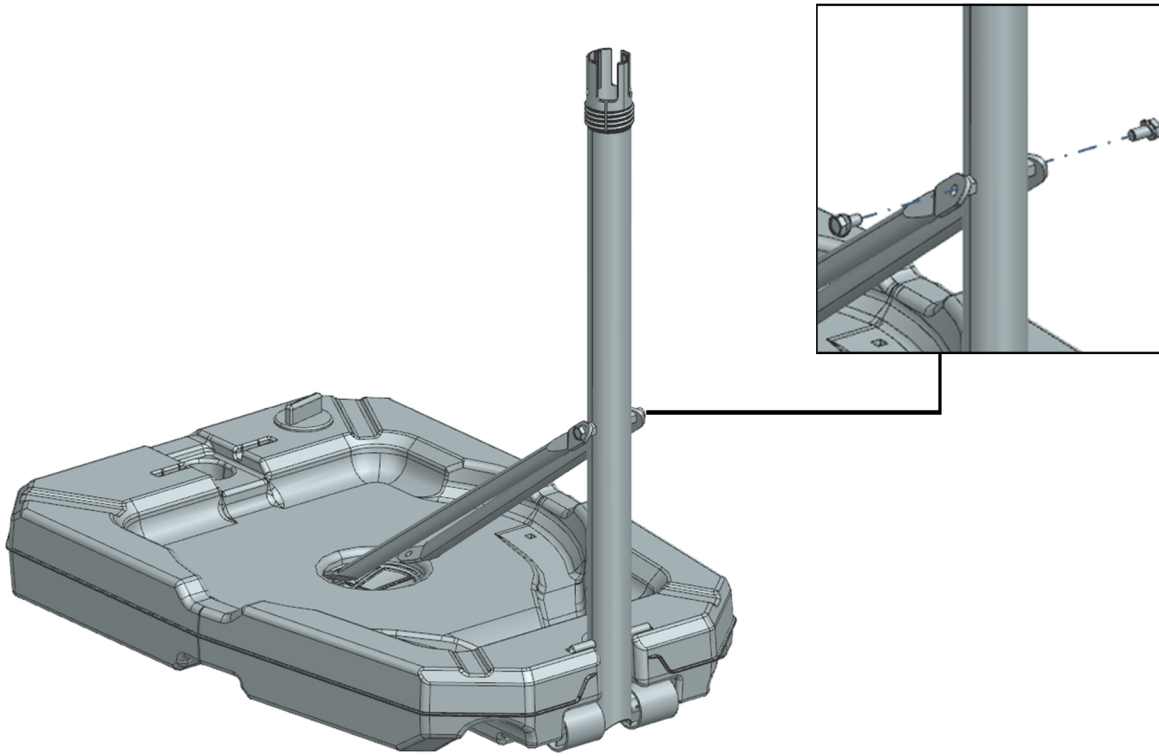

**Step 4** As shown in the figure, connect the diagonal rod (5) to the base (4) with screws (14)

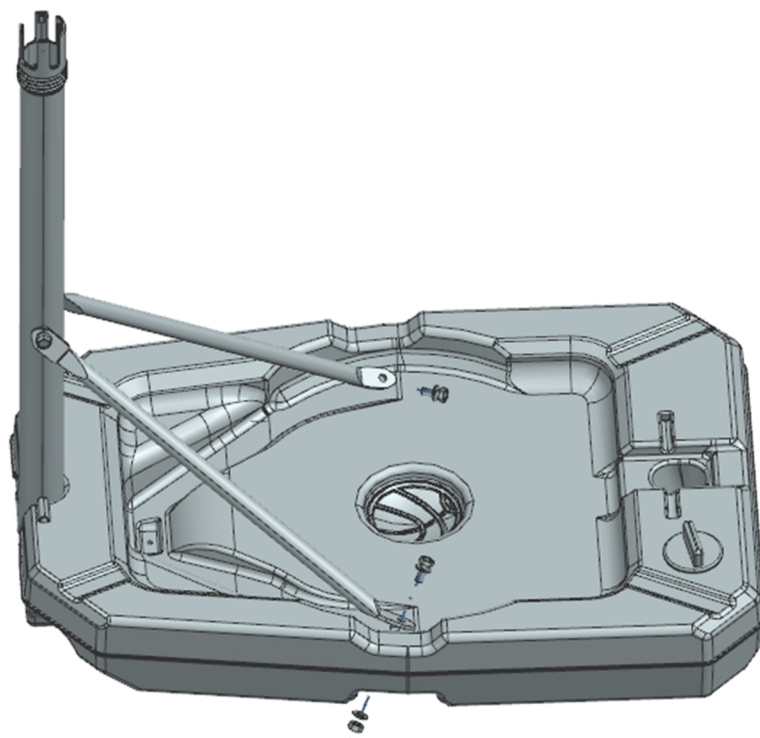

**Step 5** As shown in the figure, connect the blue circle (2), backboard (1), and fixing block with screws (10)

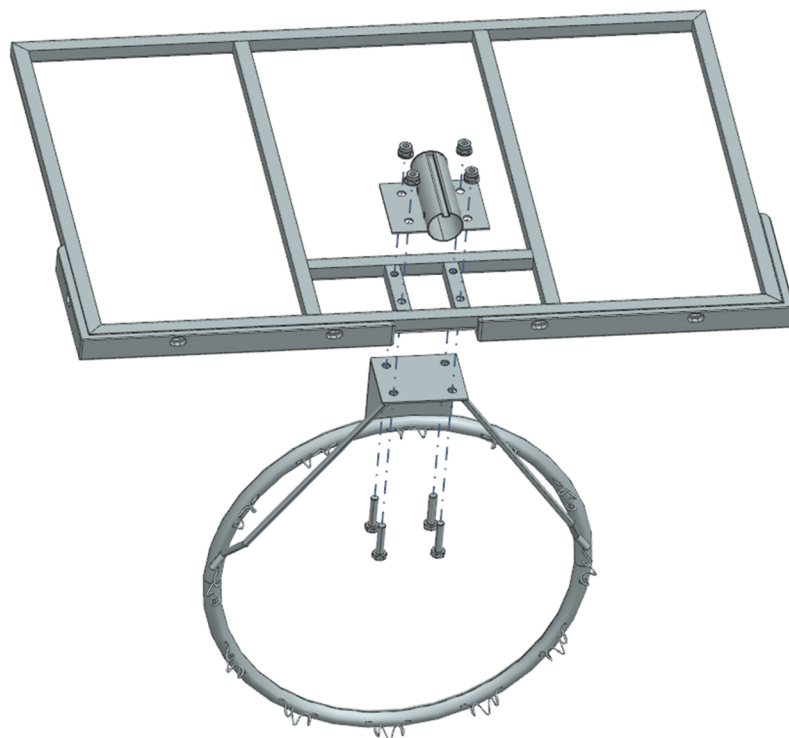

**Step 6** As shown in the figure, insert the upper rod (11) into the fixing block (10) and secure it with screws (12)

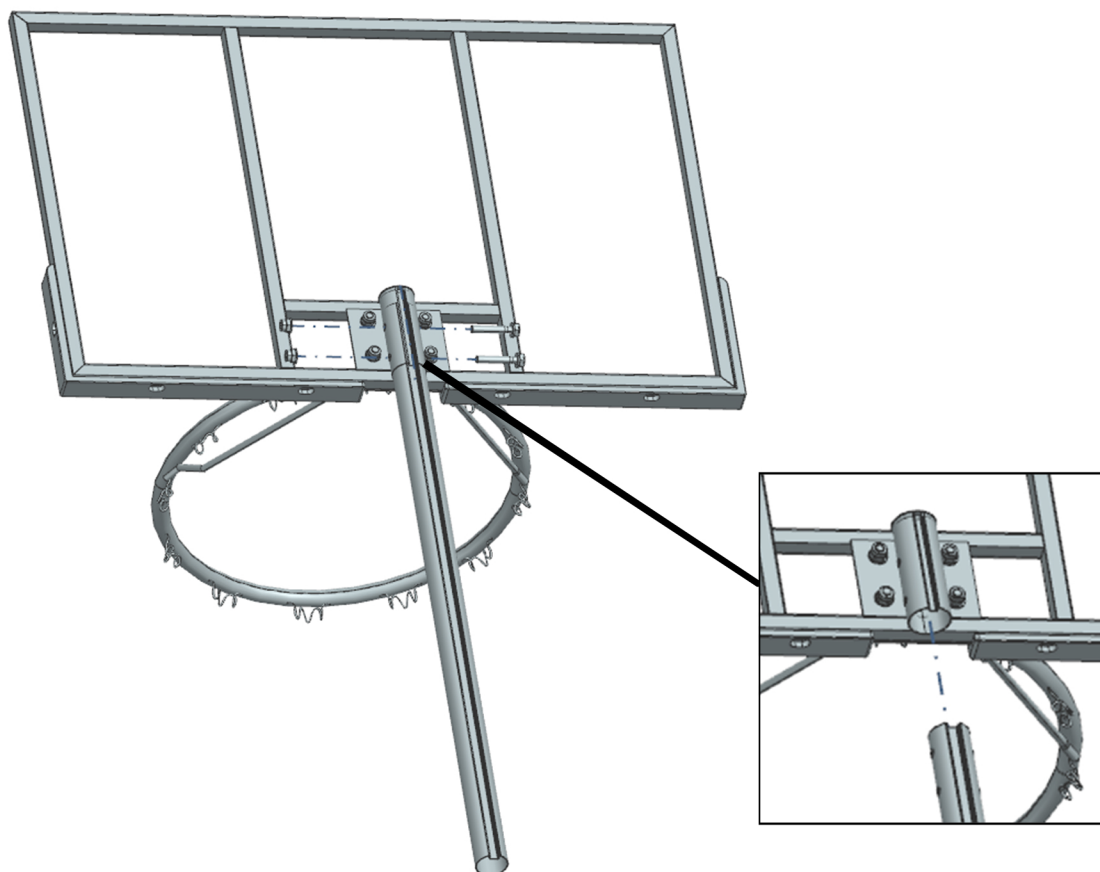

## Step 7

Connect the upper rod (11), middle rod (3), and lower rod (6) together and tighten them with a knob

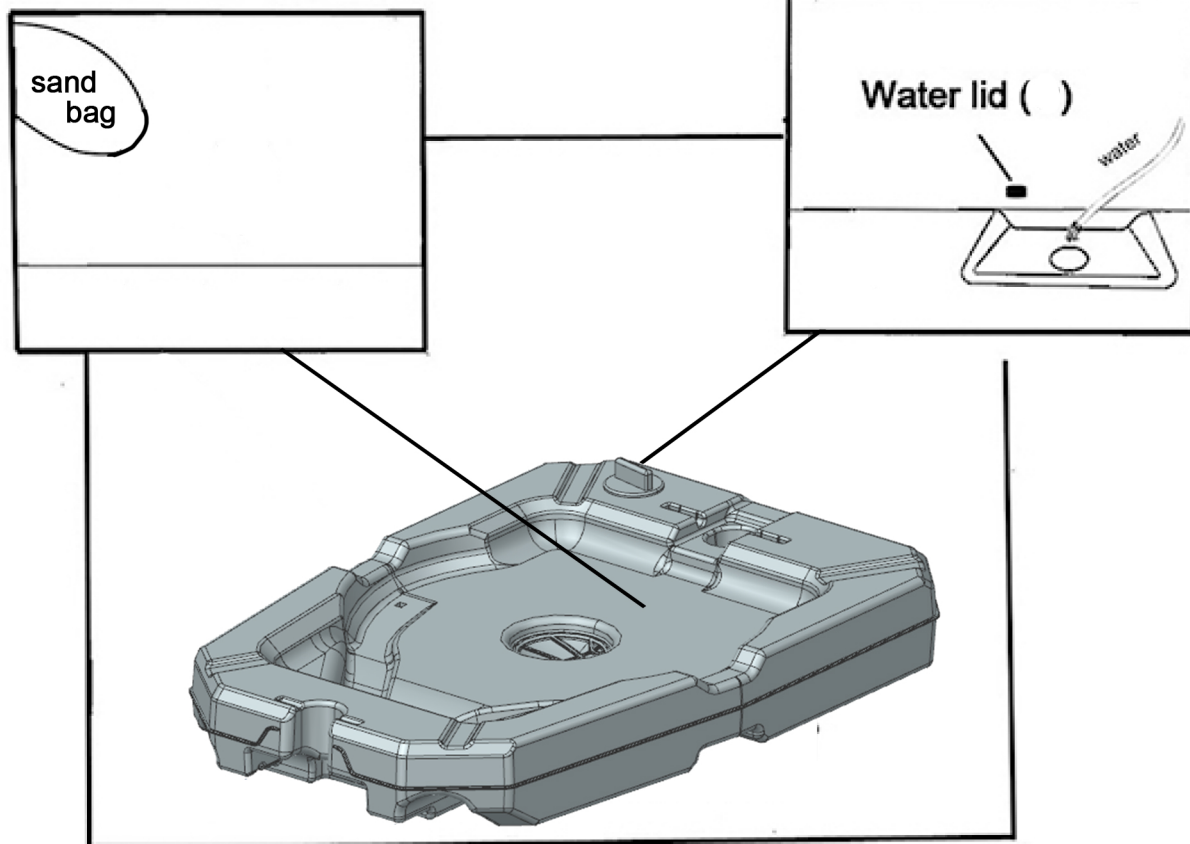

For safety reason, sand instead of water is recommended to fill up the base during the sub-freezing weather. Please note that sand will not be poured out once filled in the base