

## PARTS LIST

1. Backboard X 1
2. Rim X 1
3. Fixing Plates X 1
4. Top Tube X 1
5. Mid Tube X 1
6. Bottom Tube
7. Struts X 2
8. Base X 1
9. Steel Frame X 1

## ASSEMBLE THE BASE

- I. Use bolt F and flat washer B to secure bottom tube 6 into the base frame 9.

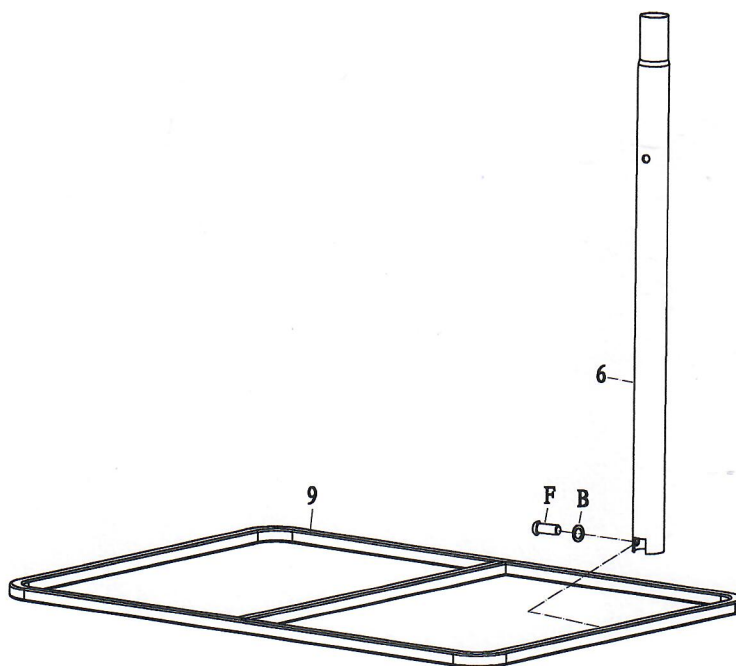

## SECURE ENDS OF BASE STRUTS TO BASE

- 2** 1. Join base struts 7 to bottom tube using bolt E and flat washers B
2. Secure end of base struts to base frame using bolt E and flat washer B

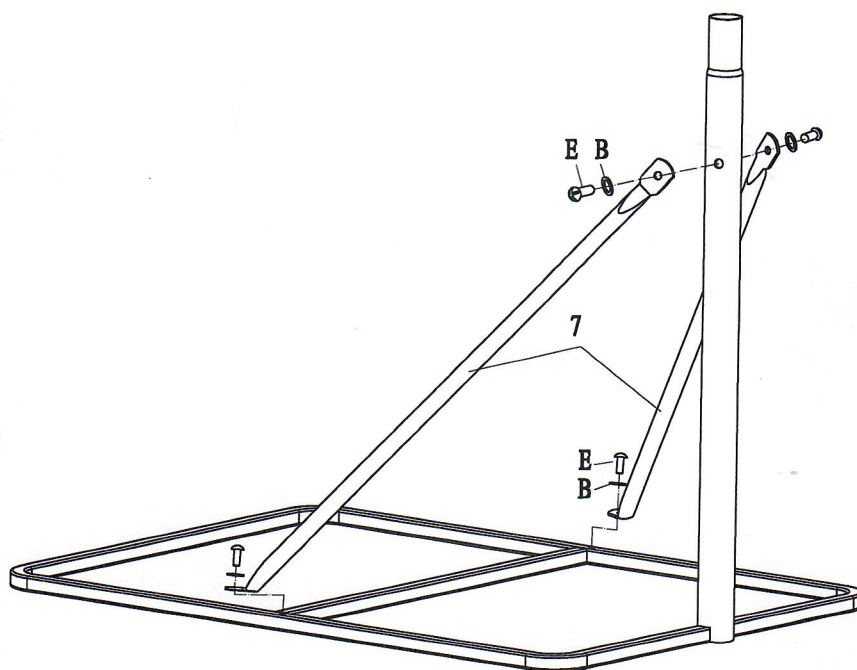

## JOINING TUBES TOGETHER

3

1. Connect following middle tube and top tube to the bottom tube using

bolt L, G and flat washer E

Place empty plastic base box 9 on the top of base frame

2. Place empty plastic base box 8 on the top of base frame

3. Fill water or sand in the plastic base box, then use rubber cap to seal base

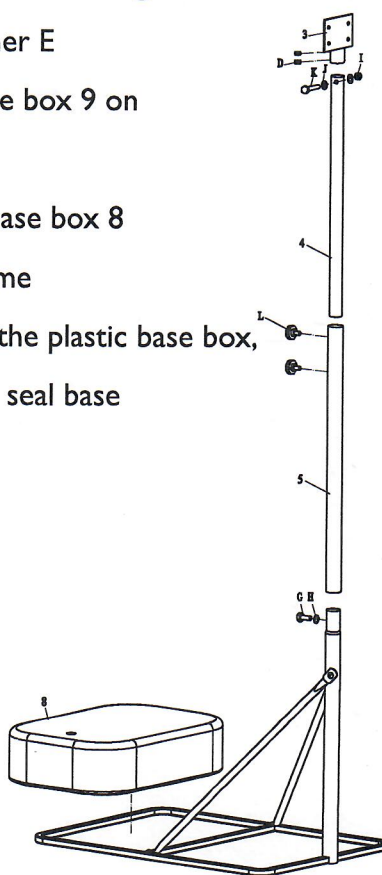

## ATTACH TUBE ONTO BACKBOARD

- 4** 1. Insert the outcome  
from step four through four  
holes of top tube  
2. Use bolt C, nut A  
and flat washer B, to  
secure the  
backboard on the  
top of tube

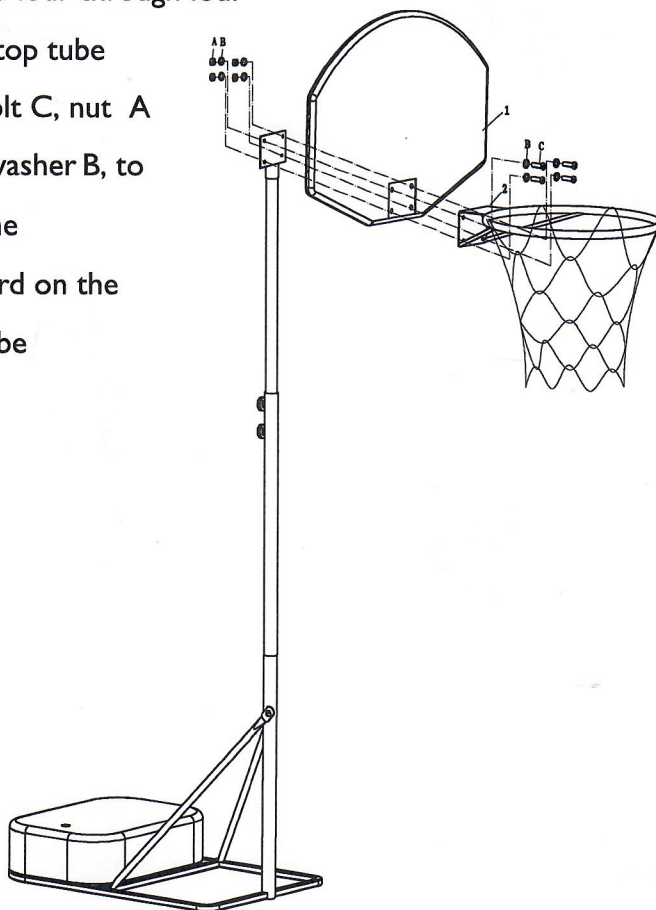



# SAFETY WARNING



## SAFETY INSTRUCTIONS



FAILURE TO FOLLOW THESE SAFETY INSTRUCTIONS MAY RESULT IN SERIOUS INJURY OR DEATH OR PROPERTY DAMAGE AND WILL VOID WARRANTY.

*Owner must ensure that all players know and follow these rules for safe operation of the system.*

To ensure safety, do not attempt to assemble this system without following the instructions carefully. Check entire box and inside all packing material for parts and/or additional instruction material. Before beginning assembly, read the instructions and identify parts using the hardware identifier and parts list in this document. Proper and complete assembly, use, and supervision are essential for proper operation and to reduce the risk of accident or injury. A high probability of serious injury exists if this system is not installed, maintained, and operated properly.

- If using a ladder during assembly, use extreme caution.
- Two (2) capable adults are recommended for this operation.
- Check base regularly for leakage. Slow leaks could cause system to tip over unexpectedly.
- Seat the pole sections properly (if applicable). Failure to do so could allow the pole sections to separate during play and/or transport of the system.
- Climate, corrosion, or misuse could result in system failure.
- Minimum operational height is 6' 6" (1.98 m) to the bottom of backboard.
- This equipment is intended for home recreational use only and NOT excessive competitive play.
- Read and understand the warning label affixed to pole.
- The life of your basketball pole depends on many conditions. The climate, placement of the pole, location of the pole, exposure to corrosives such as pesticides, herbicides, or salts are all important.
- If technical assistance is required, contact Customer Service.
- Adult supervision is recommended when adjusting height.

*Most injuries are caused by misuse and/or not following instructions.  
Use caution when using this system.*