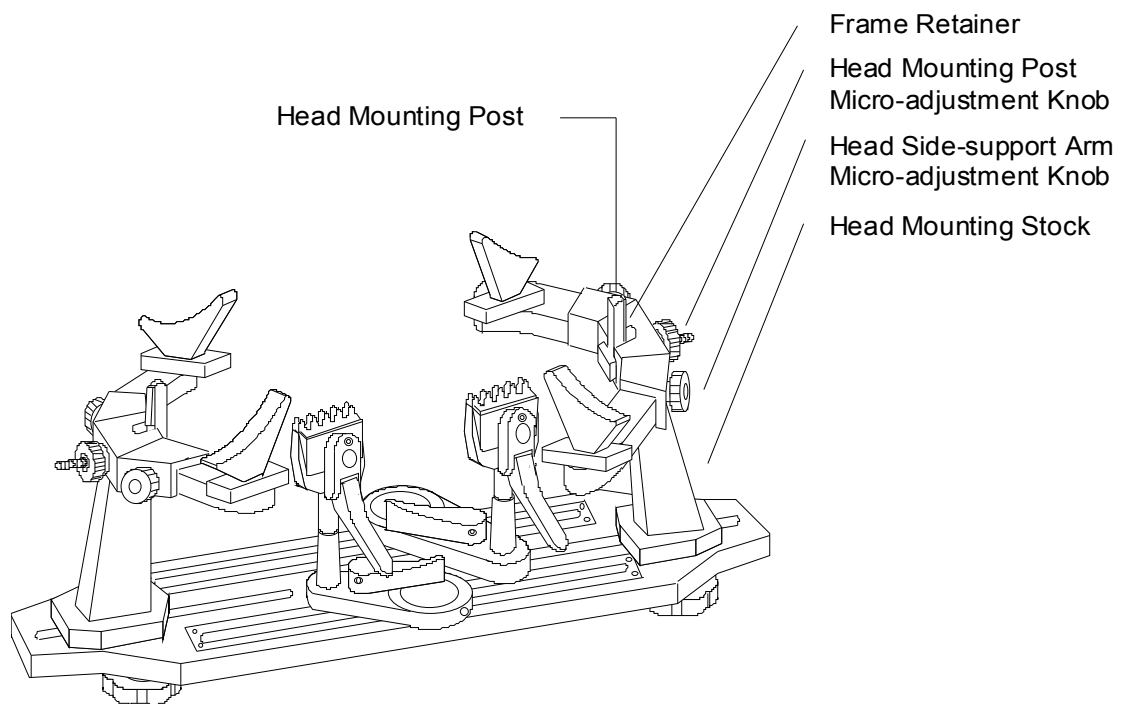
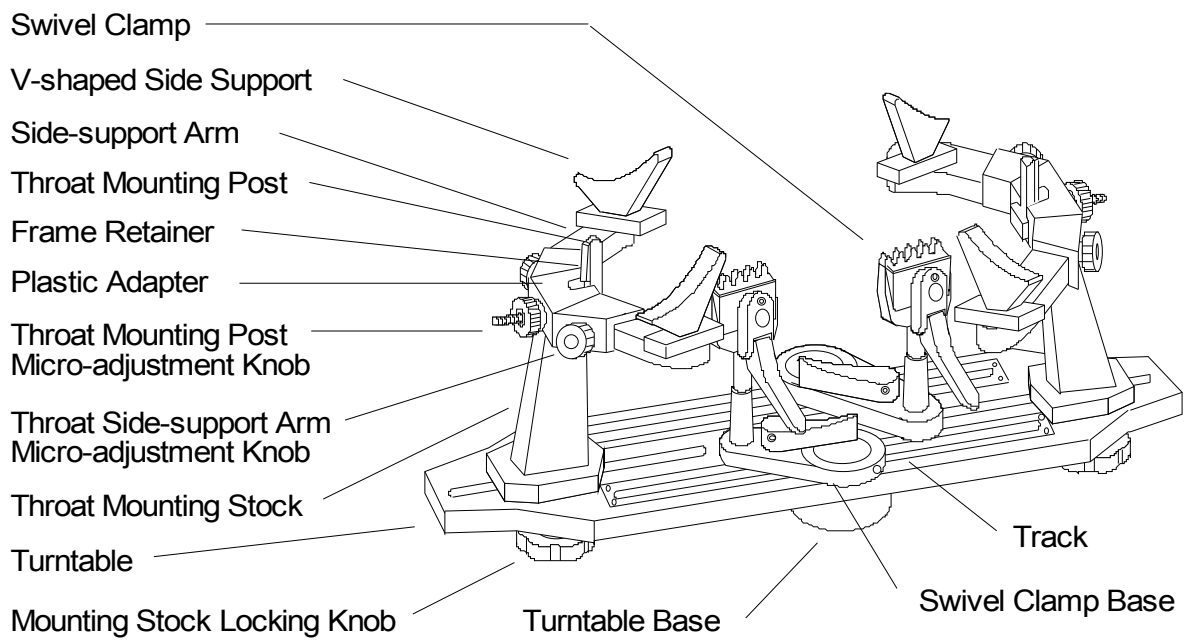

TABLE OF CONTENTS

OBSAH

<u>SECTION</u>	<u>PAGE</u>
1. UNPACKING AND INSPECTION 3	
2. INSTALLATION PROCEDURE 3	
3. MOUNTING THE RACQUET FOR STRINGING 5	
4. MAINTENANCE 6	
5. TROUBLESHOOTING 6	
<u>APPENDIX</u>	
A OPTIONS AND SUPPLIES A-1	
B ADJUST STRING CLAMP TO THE CORRECT HOLDING PRESSURE B-1	
C ADJUST THE BASE OF THE SWIVEL CLAMP TO THE CORRECT HOLDING PRESSURE B-1	
D STRINGING INSTRUCTIONS D-1	

Anatomy of Spartan Stringing Machine



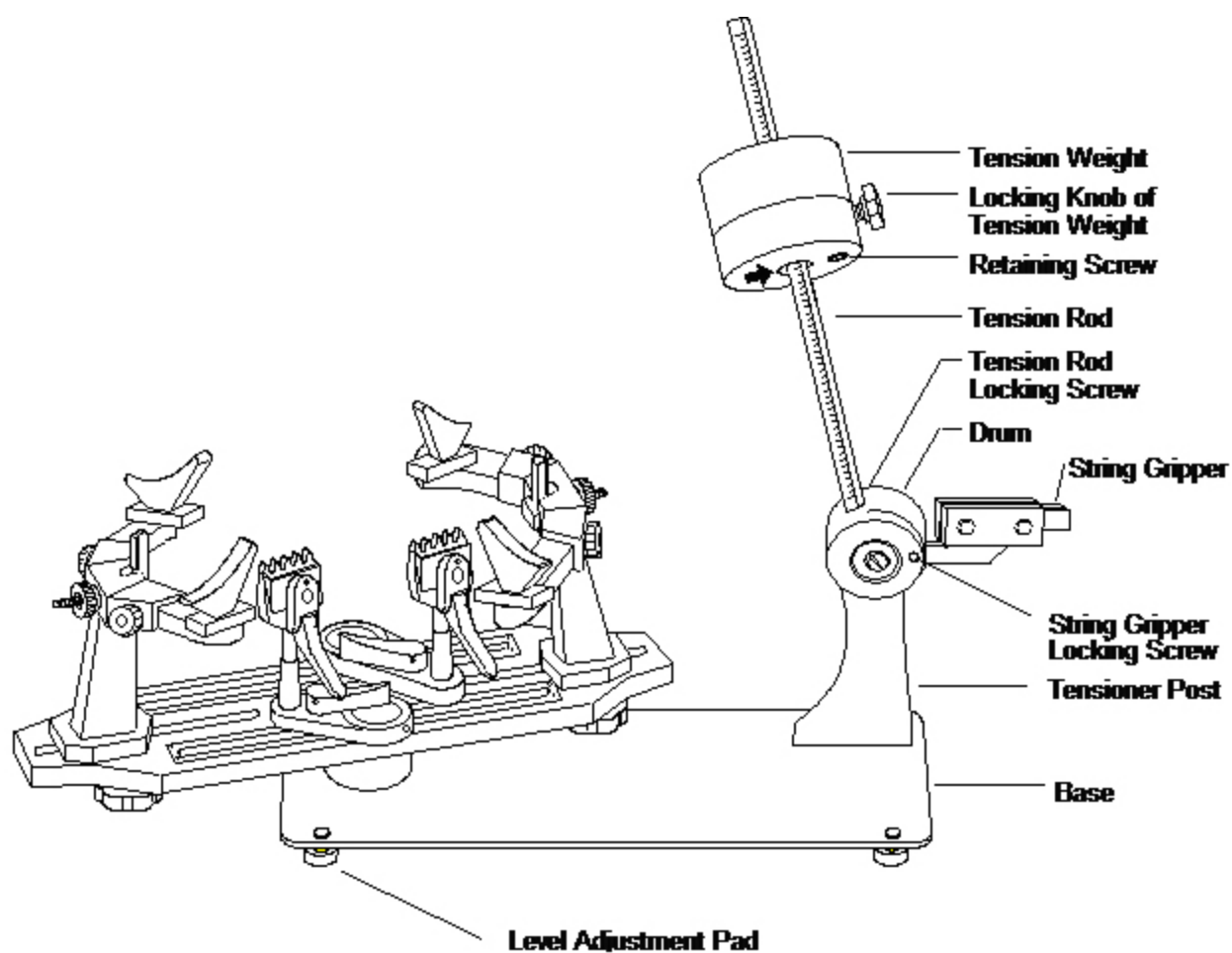

1. UNPACKING AND INSPECTION

The **Spartan** stringing machine is packaged and shipped in one carton and is protected internally by foam inserts. The **Spartan** stringing machine is packed with the following components.

One machine base assembly, one tensioner post assembly, one tension rod, one tension weight assembly (including two tension weights), one turntable assembly, two mounting stocks (including two side-support arm assemblies), two mounting post assemblies, two string clamps, one user's manual

Accessories:

four K-shaped side supports, one 6mm Allen wrench (hex wrench), one 3mm Allen wrench (hex wrench)

Before unpacking any carton, inspect the carton for damage. Unpack the **Spartan** stringing machine from the shipping carton by using the following procedure.

- Step 1. Cut the carton sealing tape and open all the carton flaps.
- Step 2. Remove the top packing protector.
- Step 3. Carefully lift the turntable assembly and tension rod out of the carton.
- Step 4. Remove the, two mounting stock assemblies, two string clamps and accessory bag out of the carton.
- Step 5. Remove the tension weight assembly out of the carton.
- Step 6. Carefully lift the tensioner post assembly and the machine base assembly out of the carton.
- Step 7. Inspect the **Spartan** stringing machine for obvious damage.
- Step 8. Remove the bottom packing protector out of the carton. The accessories sometimes fall beneath the packing protector.

This **Spartan** stringing machine has been assembled and tested in production line. After passed the inspection by the quality control department, this **Spartan** stringing machine was disassembled into a few major components and packaged into boxes for shipment.

NOTE: The **Spartan** stringing machine was pre-assembled and tested in the production line. Therefore, there are the assembly marks on the machine base, turntable and tension rod.

If any item is missing or damaged, contact your delivery agent and your sales representative. Retain the packaging materials and shipping container in the event that reshipping is required.

2. INSTALLATION PROCEDURE

- Step 1. Place the **Spartan** machine base assembly firmly on the table. Mount the tensioner post on the base. Line up two holes of the tensioner post with holes in the base. Use the 6mm Allen wrench to lock it in place by tightening these two screws.
- Step 2. Make sure the machine base rests evenly on the table. If necessary, adjust the level adjustment pad to level the machine base.
- Step 3. Lower the tension rod to the right side.
- Step 4. Use the 10mm wrench to turn the tension rod holding screw clockwise to lock it in place.
- Step 5. Mount the turntable on the turntable base. Line up four holes of the turntable with holes in the turntable base. Use the 6mm Allen wrench to lock it in place by

tightening these four screws.

- Step 6. Install the head mounting stock into the track on the turntable. Make sure the mounting stock moves smoothly along the track. Repeat this operation for the throat mounting stock.
- Step 7. Remove the mounting post micro-adjustment knob from the mounting post assembly. Slide the mounting post assembly into the head mounting stock and the side-support arm assembly. Attach the mounting post micro-adjustment knob back to the mounting post assembly. Repeat this operation for the throat mounting post.
- Step 8. Use a soft cloth to wipe off the grease out of the jaws of the **Spartan** swivel clamps. Insert these two swivel clamps into their bases on the turntable.
- Step 9. Insert the string gripper into the drum. Use the 3mm Allen wrench to lock it in place by tightening the string griper locking screw.

1.